

XT1 Feed Support Manual



INTRODUCTION:

Bow Products XT1 Feed Supports are used exclusively with Bow XT XTENDER Fences.

Feed Supports mount to the bottom of the XT EXTENDER Fences and provide additional support for material. Feeds Supports are ideal for cutting machines with small cutting surfaces such as Portable Saws or Bandsaws. If you have a wide table surface such as a Cabinet Saw, you can still position the XT XTENDER fence out from the Table Surface and use the Feed Supports. Feed Supports fit into slots on the XTENDER Fence using T-Bolts and slide along the full distance of the fence. Position Options: Infeed Position with the Fence forward, or Outfeed position with the Fence extending back, or one Support on the Infeed and Outfeed.



Standoffs

XTENDER Fences come with 4 Standoffs that slide into the bottom T-slot of the fence. Standoffs raise the fence 1/16" off the table surface. Standoffs help the XTENDER Fence slide easier on the table and prevent scratching. **STANDOFFS ALSO REGISTER THE TABLE SURFACE EVENLY WITH THE FEED SUPPORT.** Standoff Positioning is Critical when using Feed Supports. Ensure Standoffs are installed in the bottom slot of the XTENDER Fence such that they rest on the table surface.

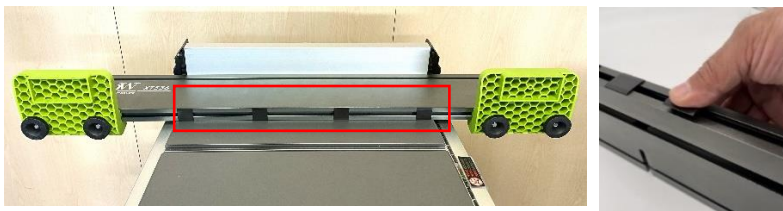

Position Standoffs over table as shown. Picture change

ASSEMBLY:

XT FENCE PROFILE

SLOT D: T-Slots for mounting Feed Support accessory.

ASSEMBLY: Insert T-Bolt through Feed Support and secure to the Knob as shown. Insert T-Bolts into the Fence Slots D, Position and secure.

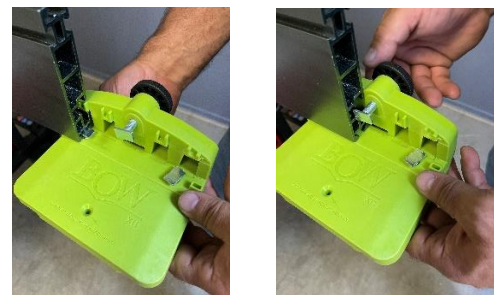

Each Feed Support contains a cavity on the bottom (inner diameter is 1-9/16" x 3-9/16") to attach a wood support if additional stability is necessary. There is a countersunk thru-hole on the Feed Support Surface to attach the board.

ENHANCE YOUR XTENDER FENCE WITH BOW FEATHERBOARDS AND PUSH STICKS



- **Bow FencePRO Featherboards (Bow Part # FP4):** FencePRO featherboards are sold in pairs and attach in the Top T-Slot providing hold down pressure for feed control and the best anti-kickback protection with our patented EVA Feather and hinge design. EVA feathers also dampen vibration and will not mar soft wood or harm blades if accidental contact.
- **Bow Table Featherboards:** Add the Safest Featherboards in the market. Bow Products patented EVA featherboards feature EVA feathers for unmatched feed control, a firm smooth glide while virtually eliminating kickback with our patented EVA feather and Hinge design. Mounts to table miter slot. Choose from the Portable Saw Featherboard (shown in the picture - Pt # FP5) for small tabletops, or the FeatherPRO FP1 or FeatherDUO FP3 for cabinet saws.
- **Bow PushPRO Push Sticks:** Featuring EVA tips for unmatched safety and vibration dampening cut control. EVA tips are replaceable and Reversible. Choose PushPRO Push Stick - Longer, Pt # PP1; or Mini PushPRO Push Stick - short Pt # PP2.

Warranty: One Year limited for defects in material or workmanship

Other Bow Products: Visit us at www.bow-products.com and see all the great products.

Customer Service: You may contact us via customerservice@bow-products.com or call us at 844.895.4488.

Bow Products Inc. 8778 Boyce Rd. Corfu, NY 14036

⚠ WARNING: When using Electric Power Tools, be sure to understand and adhere to the manufacturer's operating instructions including the safety precautions contained herein to avoid possibility of fire, Electric Shock or Personal injury.

⚠ WARNING: Always ensure the Power Tool is turned off during set up.